

# CSA

## TAPR...F

### Plain clevis

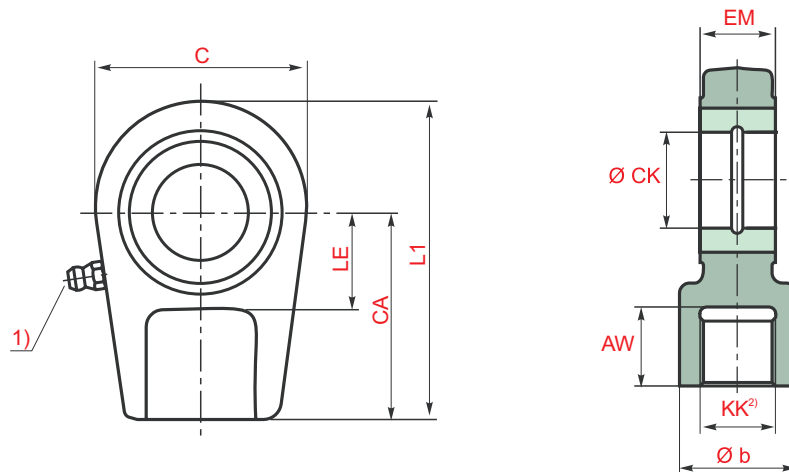

Piston Ø	Type	AW	b	C	CA	CK H11	EM -0,4	KK	LE	L1	m <sup>3)</sup> kg
40	CSA 16	17	28	56	50	25	23	M16x1,5	25	80	0,43
50	CSA 22	23	34	64	60	30	28	M22x1,5	30	94	0,70
63	CSA 28	29	44	78	70	35	30	M28x1,5	40	112	1,10
80	CSA 35	36	55	94	85	40	35	M35x1,5	45	135	2,00
100	CSA 45	46	70	116	105	50	40	M45x1,5	55	168	3,30
125	CSA 58	59	87	130	130	60	60	M58x1,5	65	200	5,50
140	CSA 65	66	93	154	150	70	55	M65x1,5	75	232	8,60
160	CSA 80	81	125	176	170	80	60	M80x2	80	265	12,20
180	CSA 100	101	143	206	210	90	65	M100x2	90	323	21,50
200	CSA 110	111	153	230	235	100	70	M110x2	105	360	27,50

\* Unless otherwise specified, all dimensions are given in millimetres.

#### Remarks:

- 1) = Grease nipple; cone head form A to DIN 71412
- 2) = Tightening moment  
The fork clevis must always be screwed against the shoulder of the piston rod.  
Then, the clamping screws must be tightened to the specified tightening torque.
- 3)  $m$  = Weight of plain clevis