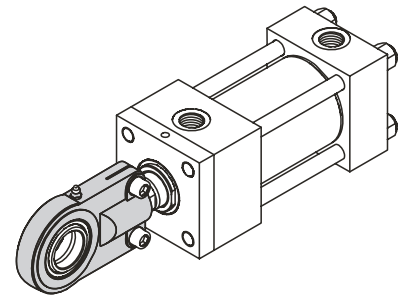

Self-aligning clevis

ISO 8133
DIN 24555

KK (Metric)	Type	CN Ø	N Ø	EN	CH ^{i s13}	AX _{min}	C _{max}	EU ^{h13}	LF _{min}	Mp ³⁾	m ⁴⁾	Ordering code
M10x1,25	ZGL 12 A3 ⁵⁾	12 ^{-0 -0.008}	17	10 ^{-0 -0.12}	42	15	40	8	16	9,5	0,15	0205003000012
M12x1,25	ZGL 14 A3 ⁶⁾	16 ^{-0 -0.008}	21	14 ^{-0 -0.12}	48	17	45	11	20	9,5	0,25	0205003000016
M14x1,5	ZGL 18 A3 ⁶⁾	20 ^{-0 -0.012}	25	16 ^{-0 -0.12}	58	19	55	13	25	23	0,43	0205003000020
M16x1,5	ZGL 22 A3	25 ^{-0 -0.012}	30	20 ^{-0 -0.12}	68	23	65	17	30	23	0,73	0205003000025
M20x1,5	ZGL 28 A3	30 ^{-0 -0.012}	36	22 ^{-0 -0.12}	85	29	80	19	35	46	1,3	0205003000030
M27x2	ZGL 36 A3	40 ^{-0 -0.012}	45	28 ^{-0 -0.12}	105	37	100	23	45	46	2,3	0205003000040
M33x2	ZGL 45 A3	50 ^{-0 -0.012}	55	35 ^{-0 -0.12}	130	46	125	30	58	80	4,4	0205003000050
M42x2	ZGL 56 A3	60 ^{-0 -0.012}	68	44 ^{-0 -0.12}	150	57	160	38	68	195	8,4	0205003000060
M48x2	ZGL 70 A3	80 ^{-0 -0.015}	90	55 ^{-0 -0.15}	185	64	205	47	92	385	15,6	0205003000080
M64x3	ZGL 90 A3	100 ^{-0 -0.020}	110	70 ^{-0 -0.20}	240	86	240	57	116	660	28	0205003000100
M80x3	ZGL 100 H2 ⁷⁾	100 H7	110	100 h12	210	96	210	84	98	385	28	0205004000100
M100x3	ZGL 125 H2 ⁷⁾	125 H7	135	125 h12	260	113	262	102	120	385	43	0205004000125

Remarks:

- 1) = Grease nipple, tapered head, form A to DIN 71412
- 2) = Associated pin Ø h6
- 3) Mp = Tightening torque
The self-aligning clevis with spherical bearing must always be screwed against the shoulder of the piston rod.
Then, the clamping screws must be tightened to the specified tightening torque.
- 4) m = Weight of Self-aligning clevis
- 5) = Cannot be lubricated
- 6) = Can be lubricated via lubricating hole
- 7) = Self-aligning clevis to ISO 6982, DIN 24338, associated spigot Ø h6